

# \$2,810,000 - 51124 R Rd 233, Rural Strathcona County

MLS® #E4430815

**\$2,810,000**

0 Bedroom, 0.00 Bathroom,

Rural on 155.99 Acres

Colchester Lane, Rural Strathcona County, AB

ENJOY rural life. Situated in Strathcona County and located 1 east of the City of Edmonton Limits. Currently being farmed. A natural treed ravine cross the lands providing for a unique settings for future country living. Excellent access via TWP 510, east to HWY 21 and west to QEII. Close to Beaumont, EIA and south east Edmonton.

## Essential Information

MLS® #	E4430815
Price	\$2,810,000
Bathrooms	0.00
Acres	155.99
Type	Rural
Sub-Type	Vacant Lot/Land
Status	Active

## Community Information

Address	51124 R Rd 233
Area	Rural Strathcona County
Subdivision	Colchester Lane
City	Rural Strathcona County
County	ALBERTA
Province	AB
Postal Code	T8B 1K6

## Exterior

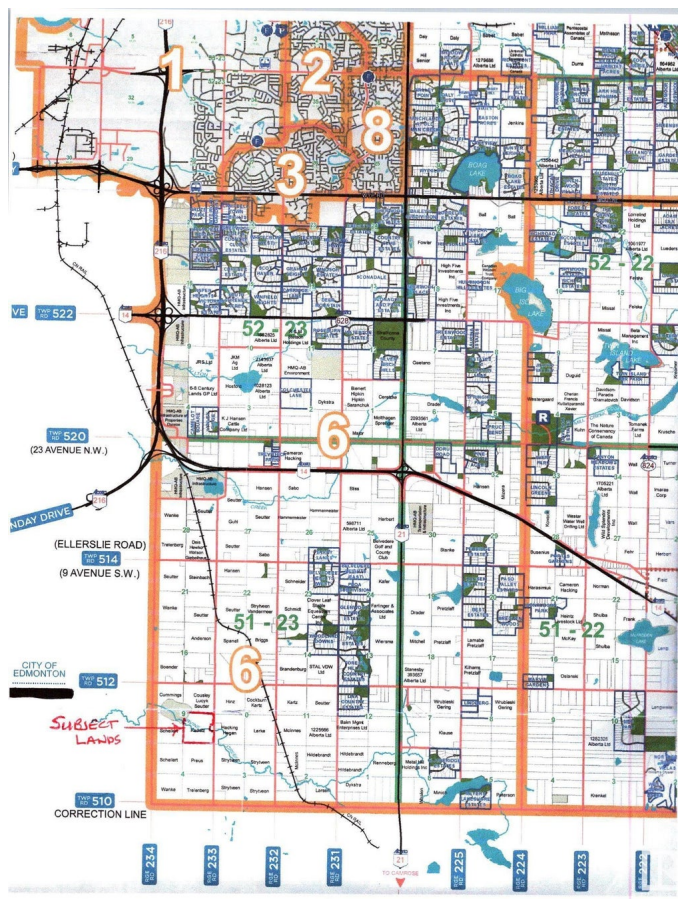

Exterior Features    See Remarks

**Additional Information**

Date Listed            April 14th, 2025  
Days on Market        2  
Zoning                  Zone 80

DATA IS DEEMED RELIABLE BUT IS NOT GUARANTEED ACCURATE BY THE REALTORS® ASSOCIATION OF EDMONTON. COPYRIGHT 2025 BY THE REALTORS® ASSOCIATION OF EDMONTON. ALL RIGHTS RESERVED.Trademarks are owned or controlled by the Canadian Real Estate Association (CREA) and identify real estate professionals who are members of CREA (REALTOR®, REALTORS®) and/or the quality of services they provide (MLS®, Multiple Listing Service®)  
Listing information last updated on April 16th, 2025 at 5:17am MDT